







**BEECHWOOD
LANDSCAPE
SERVICES**

www.beechwoodconsultingarborists.ca

LEGEND

-  EXISTING TREE TO BE REMOVED
-  EXISTING TREE TO BE RETAINED
-  CRITICAL ROOT ZONE
-  ARBORIST SUPERVISION
-  TREE TAG/NO.
-  TREE PROTECTION FENCING

NOTE:
 1. CONTACT ARBORIST (AUSTIN PETERSON, 604 614 3517, austin.peterson@beechwoodconsultingarborists.ca) 72 HOURS PRIOR TO ANY GRADING OR EXCAVATION WITHIN THE TREE PROTECTION ZONE. IF DURING EXCAVATION IT IS FOUND THAT IT CANNOT BE COMPLETED WITHOUT SEVERING ROOTS THAT ARE CRITICAL TO THE TREE HEALTH OR STABILITY, IT MAY BE NECESSARY TO REMOVE ADDITIONAL TREE.
 2. READ THIS PLAN TOGETHER WITH THE ARBORIST REPORT PREPARED BY BEECHWOOD LANDSCAPE SERVICES.
 3. IF STUMP GRINDING IS TO OCCUR IN CLOSE PROXIMITY TO TREES WHICH ARE TO BE RETAINED THEN IT IS REQUESTED STUMPS TO BE REMOVED UNDER ARBORIST SUPERVISION.
 4. IT IS THE RESPONSIBILITY OF THE CLIENT OR HIS/HER REPRESENTATIVE TO CONTACT THE PROJECT ARBORIST FOR THE PURPOSE OF:
 *LOCATING TPZ FENCING
 *LOCATING WORK ZONE AND MACHINE ACCESS CORRIDORS WHERE REQUIRED
 *REVIEWING THE REPORT WITH THE PROJECT FOREMAN OR SITE SUPERVISOR

1. 11/29/23 KD
(DD/MM/YY) NAME

REVISIONS

PROJECT CODE

PROJECT ADDRESS

718 North Road
Gibsons, BC

DRAWING TITLE

TREE MANAGEMENT PLAN

T1

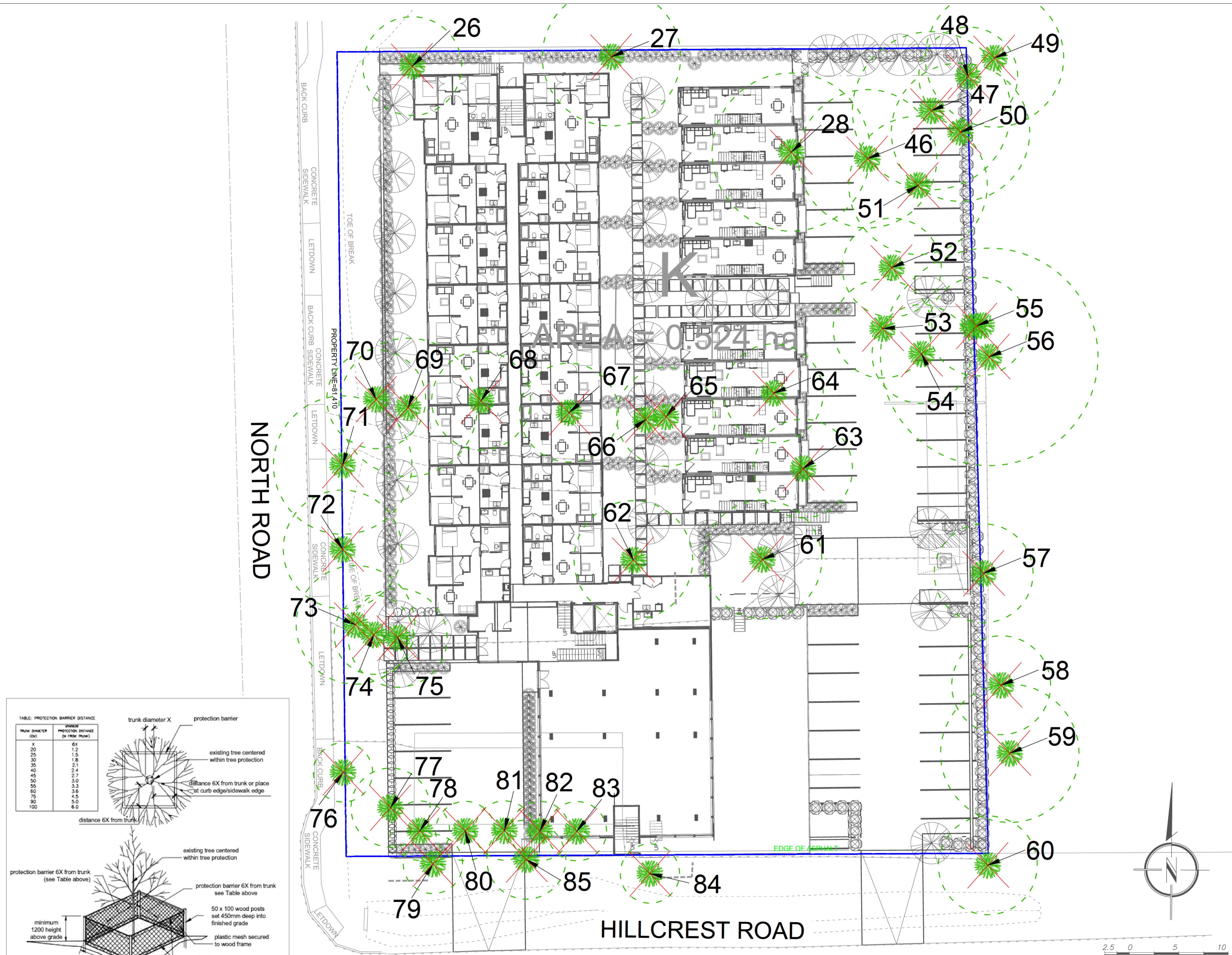

TABLE: PROTECTION BARRIER DISTANCE

TRUNK DIAMETER (CM)	MINIMUM PROTECTION DISTANCE (M FROM TRUNK)
20	1.2
25	1.5
30	1.8
35	2.1
40	2.4
45	2.7
50	3.0
55	3.3
60	3.6
75	4.5
90	5.4
100	6.0

Diagram showing trunk diameter X, protection barrier, and existing tree centered within tree protection. Labels include: distance 6X from trunk, distance 6X from trunk or place at curb edge/sidewalk edge, existing tree centered within tree protection, protection barrier 6X from trunk (see Table above), 50 x 100 wood posts set 450mm deep into finished grade, plastic mesh secured to wood frame, 50 x 100 wood rail, top and bottom, finished grade, minimum 1200 height above grade, max. spacing 2m apart, use additional posts, as required to protect trees.

