

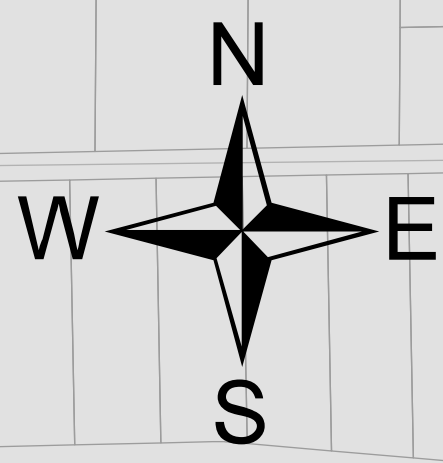

# Official Community Plan Schedule B - Land Use Plan

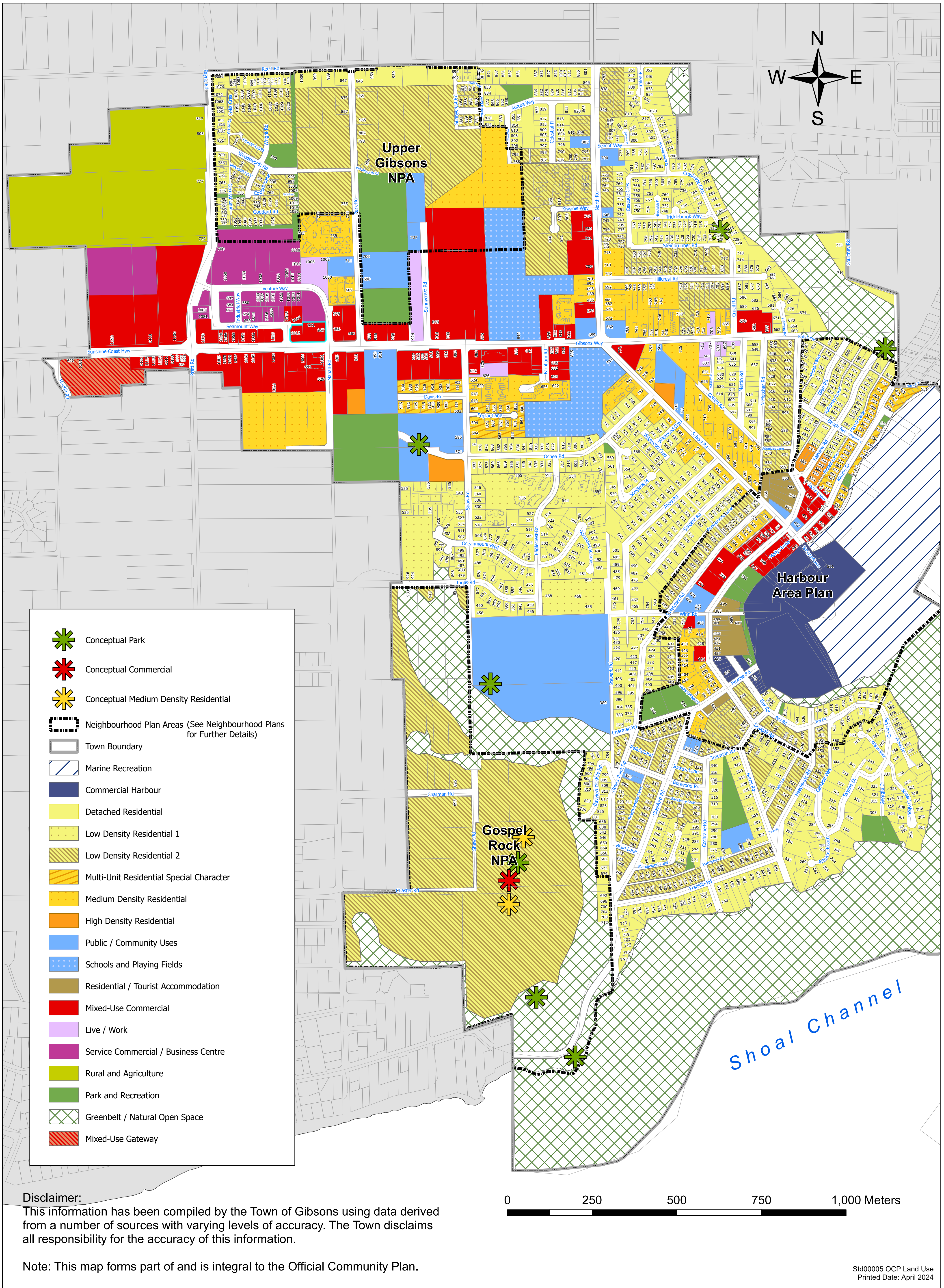

- Conceptual Park
- Conceptual Commercial
- Conceptual Medium Density Residential
- Neighbourhood Plan Areas (See Neighbourhood Plans for Further Details)
- Town Boundary
- Marine Recreation
- Commercial Harbour
- Detached Residential
- Low Density Residential 1
- Low Density Residential 2
- Multi-Unit Residential Special Character
- Medium Density Residential
- High Density Residential
- Public / Community Uses
- Schools and Playing Fields
- Residential / Tourist Accommodation
- Mixed-Use Commercial
- Live / Work
- Service Commercial / Business Centre
- Rural and Agriculture
- Park and Recreation
- Greenbelt / Natural Open Space
- Mixed-Use Gateway

**Disclaimer:**  
This information has been compiled by the Town of Gibsons using data derived from a number of sources with varying levels of accuracy. The Town disclaims all responsibility for the accuracy of this information.

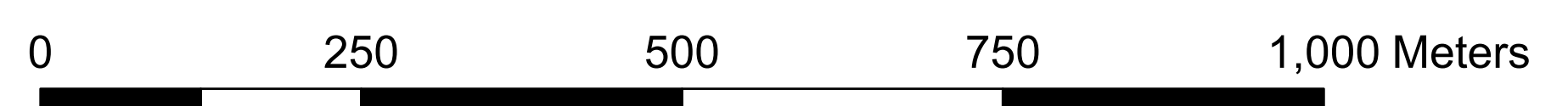

**Note:** This map forms part of and is integral to the Official Community Plan.